



**1 Bed
Flat
located in**



Flat 3, 10 Overhill Road Bristol BS16 5DN



£1,150 Per month

10 Overhill Road, Flat 3 – Recently Refurbished One-Bedroom Apartment

A beautifully refurbished, one-bedroom first floor flat, on Overhill Road, finished to a high specification throughout. This property has undergone a full back-to-brick renovation, creating a stylish and modern home perfect for a professional single or couple in a great part of Bristol.

The standout feature is the brand new shaker-style kitchen in a soft Olive green, complete with new white goods and plenty of storage space. The bathroom has also been newly fitted with a modern shower suite, offering a fresh and contemporary feel.

Offered unfurnished, allowing you to make it your own, this flat is ready for immediate move-in. This flat is at the front of the building, on the first floor with sweeping views across Bristol.

Located in a convenient spot close to local amenities, transport links, and parks, this is an ideal home for those looking for comfort, quality, and modern living in a great Bristol location. Just a few minutes walk from the vibrant High Street with coffee shops, pubs, gyms and a large Tesco.

Key Features:

Fully refurbished throughout



GROUND FLOOR
314 sq.ft. (29.1 sq.m.) approx.

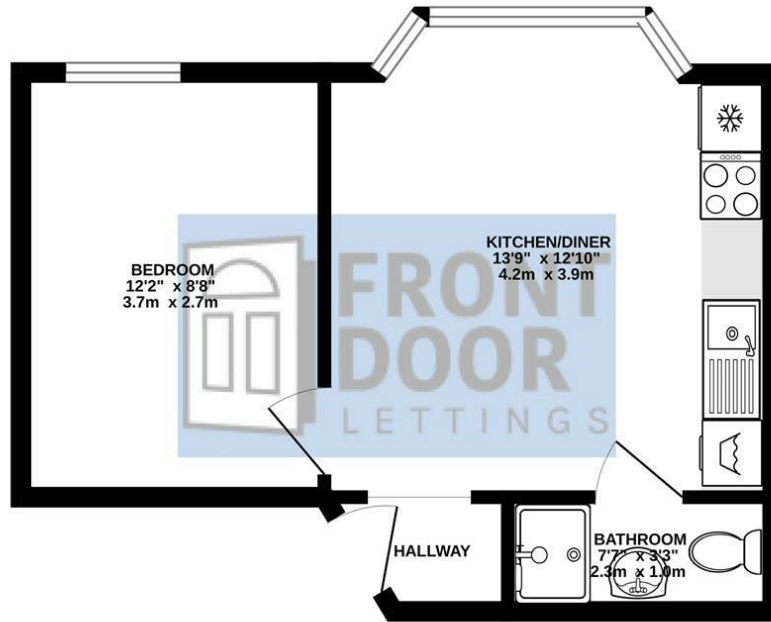

TOTAL FLOOR AREA : 314 sq.ft. (29.1 sq.m.) approx.

Whilst every attempt has been made to ensure the accuracy of the floorplan contained here, measurements of doors, windows, rooms and any other items are approximate and no responsibility is taken for any error, omission or mis-statement. This plan is for illustrative purposes only and should be used as such by any prospective purchaser. The services, systems and appliances shown have not been tested and no guarantee as to their operability or efficiency can be given.
Made with Metropix ©2025

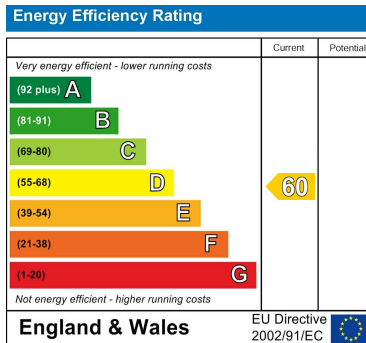

DIRECTIONS

CONTACT

Shore House Westbury Hill
Westbury-on Trym, Bristol
BS9 3AA

E: elliott.sherwood@frontdoorlettings.co.uk

T: 0117 457 8577

frontdoorlettings.co.uk

